

The OAL louvre window is suitable for natural ventilation or natural smoke (NSHEV) applications. Incorporating 'frameless' outward opening louvre blades for an all-glass look, with additional RC2 security rating and FB6 bullet resistance.

- For natural or natural smoke (NSHEV) applications.
- 40mm double/triple glazing
- Outward opening blades.
- No external framing for complete glass look.
- Insulated panel option.
- Exceptional performance.
- RC2 security rating.
- FB6 bullet resistance option.
- For installation in vertical facades
- Frame and sash profiles are thermally separated, made from composite of aluminium and PA6.6 / PT profiles
- Standard with max 80° opening angle.



EN12101-2 certified



'Frameless' external appearance.



RC2 security rating



Double/triple glazed/
aluminium panel infill



FB6 Bullet Resistance

WLF-36 Certifications & Test Data	
Glazing Panel Thickness	40mm
Glazing Types	40mm Double/Triple Glazed/Insulated Panel
Frame Depth	171mm (+25mm on driven side)
Perimeter Frame Width	22mm
Unit Width	300-1800mm
Max Frame Height	Max up to 4.5m ²
Louvre Height	200-400mm
Louvre Blade Framing	60mm (behind external glass)
EN12101-2:2003	
Aerodynamic free area	Individual Calc.
Wind Load	WL 2500
Low Ambient Temperature	T (0)
Reliability Class	Re 1000
Snow Load	SL 0
Resistance to heat	B 300-E
EN14351-1	
Air Permeability (EN12207)	Class 9A
Watertightness (EN12208)	Class 4
Wind Load Class (EN12210/12211)	Not tested
Durability (DIN EN 1191)	Class 3
Heat Transition Co-efficient (EN ISO 10077-1)	Individual calc. Up to 1.10W/m ² K.
Sound Reduction (DIN EN ISO 717-1)	Not tested
Bullet Resistance (DIN EN 1522/1523)	FB6
Burglar Resistance (DIN EN 1627)	RC2





WLF-36

Construction

- Louvre windows for installation in vertical facades
- Thermally broken frame and sash profiles manufactured from a combination of aluminium half shell profiles and plastic outer half shells.
- Louvre blades consist of double or triple insulating glazing.
- External glazing completely covers the louvre blade profile from the outside, achieving an 'all-glass' look.
- Insulated PPC aluminium skinned panel option.
- Louvre windows consist of one or more stacked louvres, which open on a central pivot. As a rule, the axis of rotation is in the middle of the louvre, but can also be modified up to 1/3 - 2/3 after technical clarification.
- Standard with max 80° opening angle.

Profile Dimensions

- Frame depth: 171 mm
- Perimeter frame width: 60 mm
- Louvre blade frame width: 60 mm

Seals

- Durable two seals with a special TPE/PP construction.

Fixings

- All unit fittings are concealed
- Made of corrosion-free or galvanised materials

Finishes

- Profiles can be anodised, powder coated or wet paint coated in RAL or special colours.
- Standard PPC to 40 Microns unless otherwise stated.

Applications

- Natural ventilation
- NSHEV certified to DIN EN 12101-2 for natural smoke ventilation
- For installation in vertical facades (further applications after technical clarification)

Size Range

- Minimum frame width: 300 mm
- Maximum frame width: 1800mm
- Minimum frame height: 440mm
- Maximum unit area: 4.5m²
- Louvre blade height variable: 120 mm to 400 mm

Control Option

24V DC

24V DC with SK3 anti-trapping

24V DC with SK3 anti-trapping & 10 year battery backup for auto close/open

Notes

Suitable for NSHEV (EN12101-2)

Suitable for NSHEV (EN12101-2)

Suitable for NSHEV (EN12101-2)



Framing Options

Our OAL range is available with a number of different control and framing options to suit most applications. Bespoke options are available.

Standard framing

For glazing/curtain walling applications

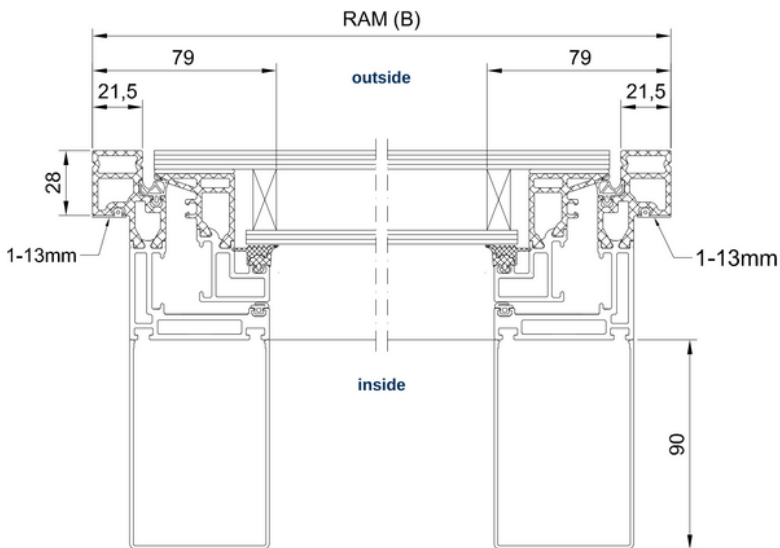

Vertical Section

(no motor shown)

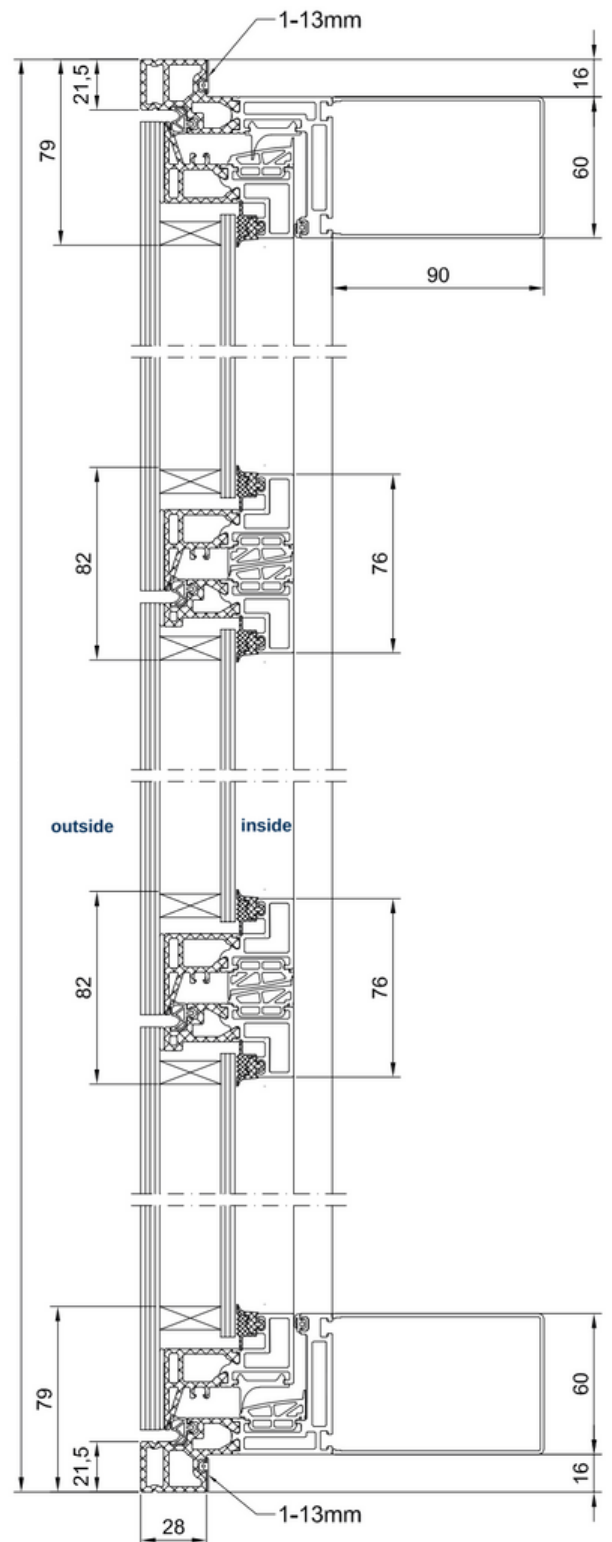

Bespoke fixing types are available, please contact head office for further information.