

The SG-J louvre window is suitable for natural ventilation applications. Supplied with single glazed square edged blades for flush finish, and non-insulated/non-thermally broken frames, the SGJ is suitable for use in non-insulated areas such as winter gardens.

- For natural ventilation applications.
- Single glazed.
- Square edged blades for a flush external appearance.
- 2mm horizontal gap between blades.
- Point fixed, all glass blades (frameless).
- 60mm 'heavy duty' frame depth.
- For installation in vertical facades
- Non-thermally broken and non-insulated frames.
- Standard with 78° opening angle, up to 90° if required.



For natural ventilation only



Contact for project specific technical details



See below for framing and motor types



Frameless single glazed square edged blades

	SGJ-60 Certifications & Test Data
Frame Depth	60mm (+25mm on driven side)
Glazing Types	Single glazed panel
Frame Width	38mm
Unit Width	300-1500mm
Max Frame Height	Unlimited (sections)
Louvre Height	120-300mm
EN12101-2:2003	Not Compliant
Aerodynamic free area	Individual Calc.
Wind Load	Not tested
Low Ambient Temperature	Not tested
Reliability Class	Not tested
Snow Load	Not tested
Resistance to heat	Not tested
EN14351-1	
Air Permeability (EN12207)	Not tested
Watertightness (EN12208)	Not tested
Wind Load Class (EN12210/12211)	Not tested
Durability (DIN EN 1191)	Class 3
Sound Reduction (DIN EN ISO 717-1)	Not tested





SGJ-60

Construction

- Louvre windows for installation in vertical facades
- Non-thermally broken frame and blade profiles manufactured from extruded aluminium.
- Louvre blades consist of point fixed, single glazed, all glass panes.
- Square edged blades for a flush external appearance.
- 2mm distance between glass edges horizontally, in closed position.
- Louvre windows consist of one or more stacked louvres, which open on a central pivot. As a rule, the axis of rotation is in the middle of the louvre, but can also be modified up to 1/3 - 2/3 after technical clarification
- Standard with 78° opening angle, up to 90° if requested.

Profile Dimensions

- Frame depth: 60 mm
- Frame view width: 38 mm

Seals

- Silicone frame seal.
- Horizontal profile joints with brush and felt seal.

Fixings

- All unit fittings are concealed
- Made of corrosion-free or galvanised materials

Finishes

- Profiles can be anodised, powder coated or wet paint coated in RAL or special colours.
- Standard PPC to 40 Microns unless otherwise stated.

Applications

- Natural ventilation
- NSHEV certified to DIN EN 12101-2 for natural smoke ventilation
- For installation in vertical facades (further applications after technical clarification) .

Size Range

- Minimum frame width: 300mm
- Maximum frame width: 1500mm
- Units exceeding maximum width will be supplied as 2 units, joining together on site,
- Slat height variable: 120- 300mm

Control Option	Notes
Manual Hand Lever	
Articulated Crank Rod	
230V AC	
24V DC	
24V DC with SK3 anti-trapping	
24V DC with SK3 anti-trapping & 10 year battery backup for auto close/open	
Pneumatic Cylinder	

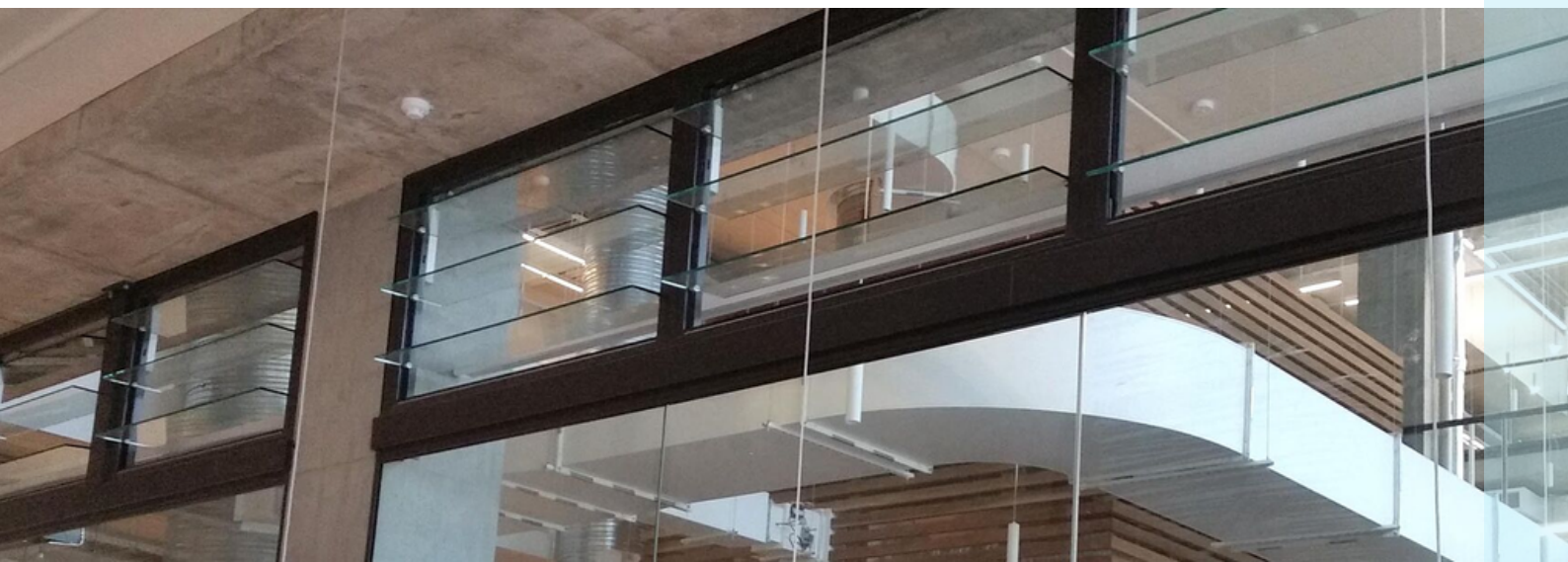

Framing Options

Our SGJ-60 range is available with a number of different control and framing options to suit most applications. Bespoke options are available.

Standard framing

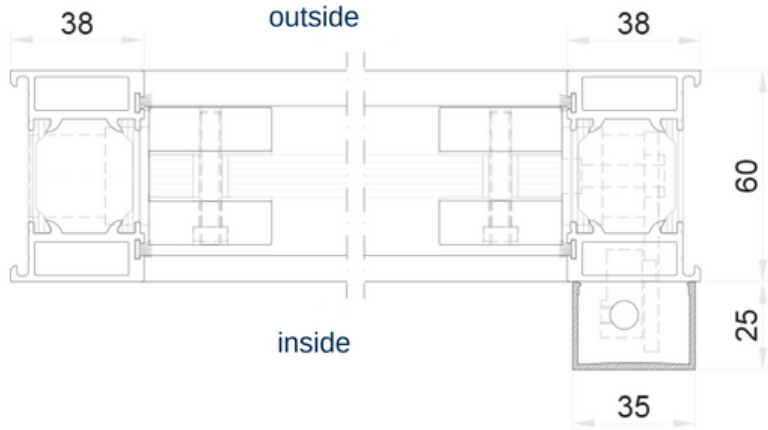

Vertical Section

(no motor shown)

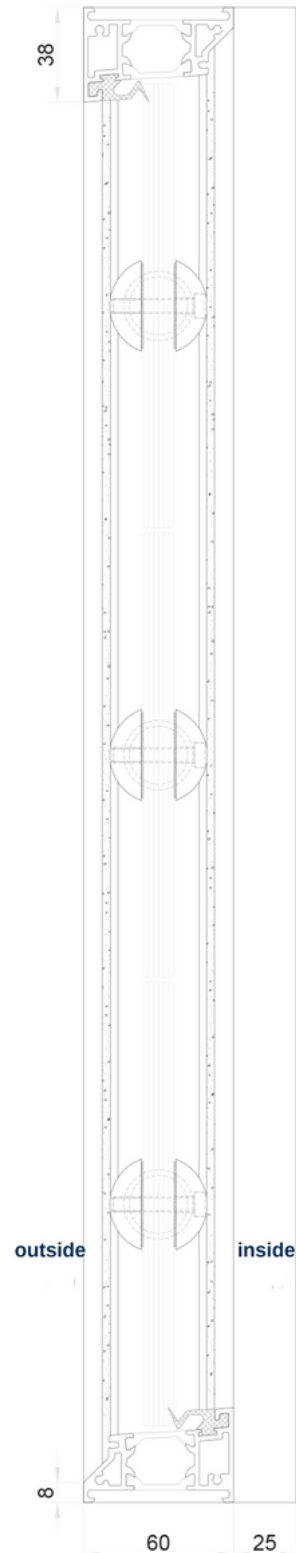

[Bespoke framing options are available, please contact head office for further information.](#)